

BLUESTEM BULLETIN

*Kansas Section, SOCIETY FOR RANGE MANAGEMENT, Newsletter
To Foster Advancement in The Art Of Grazing Land Management*

Vol. 13, No. 1

May, 2004

PRESIDENT'S CORNER

Dwayne Rice

President, Kansas Section, SRM

If you have been keeping up with the activities of the National SRM office this past year you know the national SRM leadership has been very busy. They have an improved web page www.rangelands.org that is much easier to navigate than in the past. This web site also has an archive of the JRM that can be searched by topic, author, etc. There is also a very effective and organized method of contacting section leaders with information on memberships that have lapsed. Correspondence from the national office has also improved and the chairman of the Board of Directors has been diligent at passing the information along to the section directors. These activities are a vast improvement over previous years. To continue to improve their effectiveness, the national office has asked the sections to consider sponsoring some or all of the special projects that have been requested of the national office by the members. The Washington DC office, Issue Papers, Career Brochures, and the new website are all projects that have allowed SRM to provide information on a wide variety of critical range issues, such as government relations, public relations, education and information, and scientific review. Currently, the national office doesn't have the budget to fully cover the costs of these projects. If you think the Kansas section should help partially fund one or more of these projects let me know.

There are also several activities going on within Kansas important to rangelands. The Kansas Water Authority is proposing a Strategic Plan to control Salt Cedar and Other Non-Native Phreatophytes in riparian areas across the state. This plan could assist producers in the control of these non-native species across the state and help improve the hydrology within the state's watershed areas. One of the stumbling blocks has been a lack of consensus

among the interested organizations of what the species composition of these riparian areas was historically and should be now. The Kansas SRM is working with the Kansas Grazing Lands Coalition to cosponsor a discussion forum to address this issue.

Certainly the encroachment of brush is a concern for Kansas rangelands. The number of acres infested with Eastern red cedar continues to increase across the state. Several of the cost-share programs available to producers from state and national environmental programs have directed funds specifically at controlling this rangeland weed. The Kansas section is working with the state to improve the control of trees and brush on rangelands.

The Kansas SRM is co-sponsoring several educational events this summer. One is the Range Youth Camp scheduled for July 6-9. If you know of a high school student interested in range, production agriculture, or biological science be sure to contact the camp chairman, Doug Spencer. An Adult Introductory Range Management School will be held in Council Grove August 17-19 and an Advanced Range Management School will be held in Scott County August 25-27 for owners and operators interested in furthering their knowledge and understanding of rangeland management. Anyone interested in attending either of these schools should contact David Kraft.

If you are not currently involved in any of these section activities we could use your help.

IN THIS ISSUE

- **Emergency BOD Meeting**
- **Summer Meeting**
- **Minutes Fall Meeting**
- **Kling Anderson Lecture**

**KANSAS SECTION
SOCIETY FOR RANGE MANAGEMENT
BOX 303
MANHATTAN, KS 66505**

Dwayne Rice	President
Carol Blocksome	First Vice-President
Vacant	2nd Vice-President
Vacant	Director
Keith Harmoney	Director
Karen Hickman	Director
Maurice Miller	Director
Joe Hecht	Secretary-Treasurer
Jeff Davidson	Past President
Pat Broyles	Historian
Walter Fick	Newsletter Editor

Blocksome (1st VP).

The item of utmost urgency was the lack of elections in the past year. In reviewing the by-laws, it was found that a new election cycle would start within a month. In short, there were no elections last year; as a result, ballots will include positions left nfilled last year as well as the normal set of positions to be filled this year.

At the meeting, the following actions were proposed:

- Current officers and committee members whose terms recently expired (within the last year) are asked to remain in office until elections can be held.
- Elections will be held in accordance with the bylaws of the Section.
- The new chair of the nominating committee (Jeff Davidson) will be contacted & asked to prepare a slate of candidates for all open positions. This slate of candidates would be turned in to the President (Dwayne Rice) by 1 May.
- The President will submit the list to the BOD for approval.
- The approved list of candidates will be supplied to the Secretary (Joe Hecht) in time for him to prepare the ballots & send them out to the membership by 1 July.
- The elections committee, appointed by the President (Dwayne Rice), will receive the ballots & count them.
- Installation of officers occurs at the annual meeting in the fall according to the by-laws. However, the BOD is proposing an amendment to the by-laws that would change this.

In order to eliminate confusion, allow time to prepare final reports after the annual meeting, align with the fiscal year, and establish a firm date for the transfer of duties & responsibilities, the BOD proposes an installation date of 1 January following the annual meeting. This proposed amendment will be submitted to a membership vote in the upcoming elections. If the amendment is successful, the successful candidates in the upcoming elections would be installed on 1 January 2005.

Submitted by Carol Blocksome, 1st VP, Kansas Section SRM

EDITOR'S COMMENTS

Subscriptions to the Bluestem Bulletin are available to non-SRM members at \$5 per year. Send remittance payable to the Kansas Section, SRM to Walter Fick, Dept. of Agronomy - TH, Kansas State Univ., Manhattan, KS 66506.

We now have the capability to electronically send the Bluestem Bulletin. If you would like to receive the newsletter via e-mail please contact me at the above address or at (785) 532-7223 or whfick@ksu.edu.

Submission deadline for the next issue of the Bluestem Bulletin: June 25, 2004

EMERGENCY BOD MEETING

An emergency meeting of the Board of Directors (BOD)- Kansas Section Society for Range Management was held 29 March 2004 at 7:00 PM at the KSU Agricultural Research Center, Hays, KS. Those in attendance were Keith Harmoney (BOD member), Maurice Miller (BOD member), and Carol

The summer meeting of the Kansas Section-SRM will be June 3-4, 2004 in Auburn, KS. We will visit producer Wayne Copp's farm Thursday afternoon and hear about his experiences with patch burning, multi-species grazing, and vegetation improvement. After a cook-out on Thursday evening, we will have our Section business meeting. The next day we will have 2 seminar sessions: rangeland fragmentation and its effects on the environment, and carbon sequestration under grasslands. Attached is a schedule of presentation topics and speakers.

Lodging is available in Topeka, less than 10 miles away. There are numerous hotels/motels available. A selection of motels is listed below.

Best Western Candlelight	800.223.8892
Courtyard by Marriott	785.271.6165
Days Inn	800.329.7466
Super 8	785.273.5100
Comfort Inn	800.228.5150

Registration for the meeting is \$15 (includes supper and lunch).
To register please contact Carol Blocksom by May 26 at blocksom@ksu.edu or 785-532-0416.

Exit 353 (Auburn Rd) off of I-70

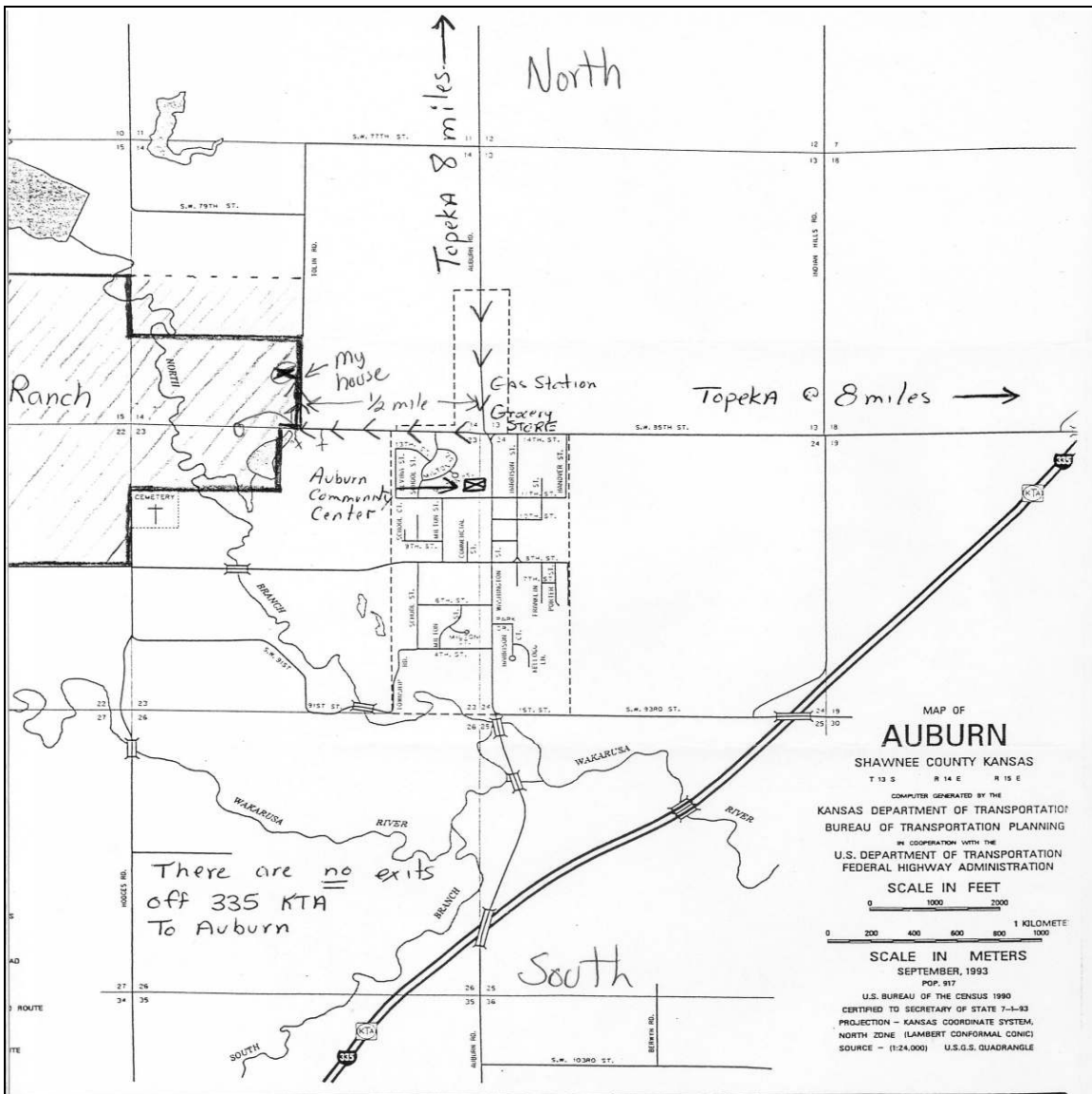

Minutes - Kansas Section, Society for Range Management

President Jeff Davidson called the annual meeting of the Kansas Section to order at 7:10 p.m. on September 24, 2003 at Hays, KS. The minutes of the June 24 meeting were approved as published in the Bluestem Bulletin. Walt Fick reported \$7,777.53 in the bank account. Davidson reviewed the summer meeting and patchburn tour held in conjunction with the Southern Section in Missouri. The 2003 Range Youth Camp chaired by Doug Spencer had 29 participants. Doug has agreed to chair the camp again in 2004. The camp will be held July 6-9 at Rock Springs. The Advanced Range Management School held in August at White Memorial Camp near Council Grove had 19 participants. Next year the advanced school will be held at Camp Lakeside north of Scott City on August 25-27. The Basic Range Management School held in late August at Camp Lakeside had 14 participants. The basic school will be located at White Memorial Camp on August 11-13 in 2004.

Information & Education: Karen Hickman reported that a typical tri-fold brochure promoting the section and Kansas rangelands could be printed at Ft. Hays State University for \$304 (500 copies). One thousand copies would cost \$333. Information from the section poster prepared by Keith Harmoney could be used in the brochure. Distribution of the brochures and how to provide information on SRM membership was discussed. A motion was passed to have the I&E Committee proceed with having a brochure published.

Newsletter: Fick reported that he distributed 326 newsletters in September with an additional 15 e-mailed via Dwayne Rice. E-mail will be used more in the future to distribute the Bluestem Bulletin. Tom Norman agreed to help distribute newsletters within Kansas Department of Wildlife and Parks. Fick discussed possibility of advertising in the newsletter and the need to get timely management tips published.

Awards: Davidson reported that Tom Eddy, Chair of the Awards Committee had forwarded one nomination for the section Trail Boss Award. The nomination of Walter Fick was approved with the award to be presented at the next section meeting. Since the Kansas Section has not presented a Trail Boss Award before discussion was held on what the award should be. The old K-O Section normally presented a plaque to the Trail Boss awardee.

Membership: Rice commended the SRM office for keeping the section informed of membership changes, i.e. new members, lapsed members, etc. Currently the Kansas Section has 107 members.

Kansas Natural Resource Legacy Alliance: Elmer Finck reported that the alliance met in Hays on September 24, 2003. Former Governor Graves established this alliance to look at more efficient ways to address natural resources in Kansas. They have identified 10 issues and

recommendations to be made to the legislature. At the alliance meeting Finck observed that grasslands were not being directly addressed by the proposed make-up of the board. He suggested that the Kansas Section, SRM would be an appropriate organization to represent grasslands. His suggestion was taken under advisement. It was suggested the president of the Kansas Section should write a letter to Shelia Frohm, chair of the Kansas Natural Resource Legacy Alliance, informing her of the importance of grasslands in Kansas and the mission and objectives of the Society for Range Management. Tom Norman suggested that the letter should not necessarily ask for representation from the Kansas Section, but that the interests of grasslands be included. The issues and recommendations of the alliance can be accessed on the web at <http://www.kdwp.state.ks.us/alliance/alliance.html>.

Spring Meeting: Carol Blocksome indicated that the next meeting will be held the first week of June at Auburn, KS. The meeting would be held in conjunction with the Southern Section and include a tour of Wayne Copp's bison operation. Fragmentation (urban sprawl) might also be an issue addressed. It was suggested that both the Tallgrass Legacy Alliance and the Kansas Chapter of the Wildlife Society be contacted about participating or co-sponsoring this event.

September 25 Tour: Hickman indicated that people are to meet and register at 9:00 a.m. tomorrow in 303 Albertson Hall. Attendees will be transported by vans to tour stops in the morning and returned to campus for lunch and the early afternoon program.

Other Items: Tom Norman wondered whether the section was interested in helping provide training for teachers and field-trip oriented classes for elementary school children related to understanding the prairie. Karen Hickman noted that she was currently involved with a project targeting certain middle schools in southwest Kansas on this very topic. Paul Ohlenbusch suggested that the Konza Prairie model might be worth looking at. Elmer Finck noted that the Department of Education has a mandate to provide "natural resource and environmental education" to middle school children.

Paul Ohlenbusch indicated he was going to rebuild the Kansas Section web site. He is looking for input and information to be put on the web, e.g. section handbook, range youth camp brochure, info on range management schools, etc. He also noted he was going to change the URL using a redirect service so that location and maintenance of the web site can be moved to any server in the future.

The meeting was adjourned at 8:45 p.m.

Respectfully submitted, Walt Fick

CALENDAR OF EVENTS**Kling L. Anderson Lecture**

- May 12 Kling Anderson Lecture,
Manhattan, KS
- June 3-4 Joint Kansas and Southern Section,
SRM Meeting and Tour, Auburn,
KS
- July 6-9 Kansas Range Youth Camp, Rock
Springs 4-H Camp
- August 10-11 Nebraska Grazing Conference,
Kearney, NE
- August 17-19 Introductory Range Management
School, White Memorial Camp,
Council Grove, KS
- August 25-27 Advanced Range Management
School, Camp Lakeside, Scott City,
KS
- February 58th Annual SRM Meeting,
5-11, 2005 Ft. Worth, TX

The 13th annual Kling Anderson Lecture will be presented on May 12, 2004 by Dr. Joe Trlica of Colorado State University. The title of his lecture will be "Grazing Effects on Riparian Ecosystems." The lecture will be presented at 4 p.m. in 1014 Throckmorton Hall on the campus of Kansas State University in Manhattan.

Dr. Trlica is known for his range plant physiology research on carbon allocation in relation to grazing and the impact of grazing on mountain riparian systems. His research has produced more than 100 technical publications. He has guided 18 Ph.D and 16 M.S. students. He is also the recipient of the Society for Range Management's W.R. Chapline Research Award.

The lectureship was established to enhance training in range and forage management at Kansas State University by providing the opportunity for students and faculty to benefit from interaction with outstanding scholars. The lectures and seminars provided through this program help perpetuate and honor the name of Kling L. Anderson and commemorate his many years of outstanding service to K-State and the range management profession.